

SIDE BY SIDE

DYNAMIC DUO

- Modular design ideal for high profit desserts.
- Dry Storage Cabinet attaches to one or both sides.
- High efficiency refrigeration, automatic defrost.
- 5 topping pans included. (Optional: 5 syrup jars and 4 pumps.)



Assembled view



Dry storage cabinet



Model SKF2A

SILVER KING[®]
WE'VE GOT REFRIGERATION DOWN COLD™

FOUNTAINETTE/DRY STORAGE SPECIFICATIONS

MODEL SKF2A	EXTERIOR	Stainless steel. Galvanized back. Stainless steel back optional.
	INTERIOR	Corrosion-resistant material with coved corners throughout for fast, easy, cleaning and sanitation.
	INSULATION	Environmentally friendly foamed-in-place polyurethane insulation for maximum insulation, strength and durability.
	DOOR	Polyurethane insulation, extruded aluminum frame, stainless steel exterior door panel and extra heavy-duty magnetic "Thermo Rubber" door gasket.
	PREP SURFACE	Five topping pans — two 1/6 size (6" deep) with covers and ladles, and three 1/9 size (4" deep) with covers. Dry Storage Cabinet features 20 3/4" deep x 21" wide work surface plus back splash with appliance receptacle cut-out.
	REFRIGERATION	CFC-free, 134a refrigerant, hermetically sealed, high efficiency, self contained refrigeration system features automatic defrost and forced air circulation. Adjustable temperature control and built-in temperature indicator standard. Automatic condensate evaporator means no plumbing or floor drains.
	ASSEMBLY	Dry Storage Cabinet easily attaches to either side of fountainette with eight screws. Holes are pre-drilled and tapped.
	ELECTRICAL	Standard 115 volt, 60Hz, single phase. 8 foot, 3-wire power cord with NEMA 5-15 plug.
	LISTINGS	Underwriters Laboratories, Inc. (U.S. and Canada), NSF International
	WARRANTY	One year materials and workmanship warranty on cabinet and refrigeration system. Five year warranty on compressor.
	OPTIONS	Also available with 5 syrup jars and four pumps, including one heavy duty chocolate syrup pump.

MODEL	EXT. DIMENSIONS		STORAGE CAPACITY	SHELF AREA	NUMBER OF SHELVES	AMPS	COMPRESSOR	SHIPPING WEIGHT
	LENGTH	DEPTH						
SKF2	27"	287/8"	6.0 cu. ft.	8.8 sq. ft.	2	4.6	1/8 hp	210 lbs
10345-01	21"	287/8"	7.5 cu. ft.	6.1 sq. ft.	1	N/A	N/A	55 lbs.



Specifications subject to change without notice.

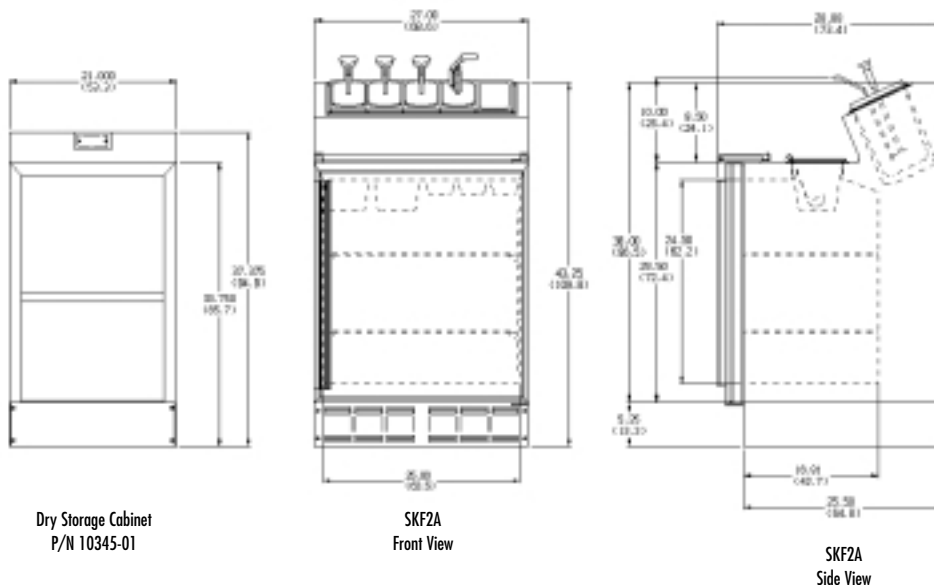

1600 Xenium Lane North
 Minneapolis, MN 55441-3787
 Phone (763) 923-2441
 Fax (763) 553-1209
 www.silverking.com

#FN9810
 © Silver King 2002
 Printed in U.S.A.

T A B L E T O P

SUNDAE SHOP

- Quality stainless steel construction throughout
- Maximum capacity, minimum space requirements
- Puts refrigerated toppings at your fingertips
- Dripless spouts eliminate mess and waste



Model SKRCF

SILVER KING[®]
WE'VE GOT REFRIGERATION DOWN COLD™

COUNTERTOP FOUNTAINETTE SPECIFICATIONS

MODEL SKRCF	EXTERIOR	Stainless steel.
	INTERIOR	Stainless steel with coved corners throughout for fast, easy cleaning.
	INSULATION	Environmentally friendly foamed-in-place polyurethane insulation for maximum insulation, strength and durability.
	REFRIGERATION	CFC-free, hermetically sealed, high efficiency, self contained system with fan cooled condenser. Cold wall evaporator provides optimum cooling of syrup and crushed fruit jars. Adjustable temperature control and built-in temperature indicator. Manual defrost.
	ELECTRICAL	Standard 115 volt, 60 Hz, single phase. Also available in 230 volt-50 Hz, single phase. Furnished with 8 foot, 3-wire service cord and NEMA 5-15P plug.
	LISTINGS	ETL (U.S. and Canada), NSF International.
	WARRANTY	One year parts and labor warranty on cabinet and refrigeration system. Five year warranty on compressor.
	OPTIONS	Four 3 1/2 quart white syrup jars with pumps, including one heavy-duty chocolate syrup pump. Four 2 1/2 quart white crushed fruit jars with stainless steel tops and ladles. Jars are chip, boil and stain-proof polypropylene. Pumps are contamination-proof with dripless spouts for no waste, no mess. Pumps and jars are optional.

MODEL	LENGTH	DEPTH	HEIGHT	COMPRESSOR	AMPS	SHIPPING WEIGHT
SKRCF	53 1/8"	13 5/16"	13 5/8"	1/8 hp	2.5	109 lbs



Specifications subject to change without notice.

Dimensions in inches and centimeters

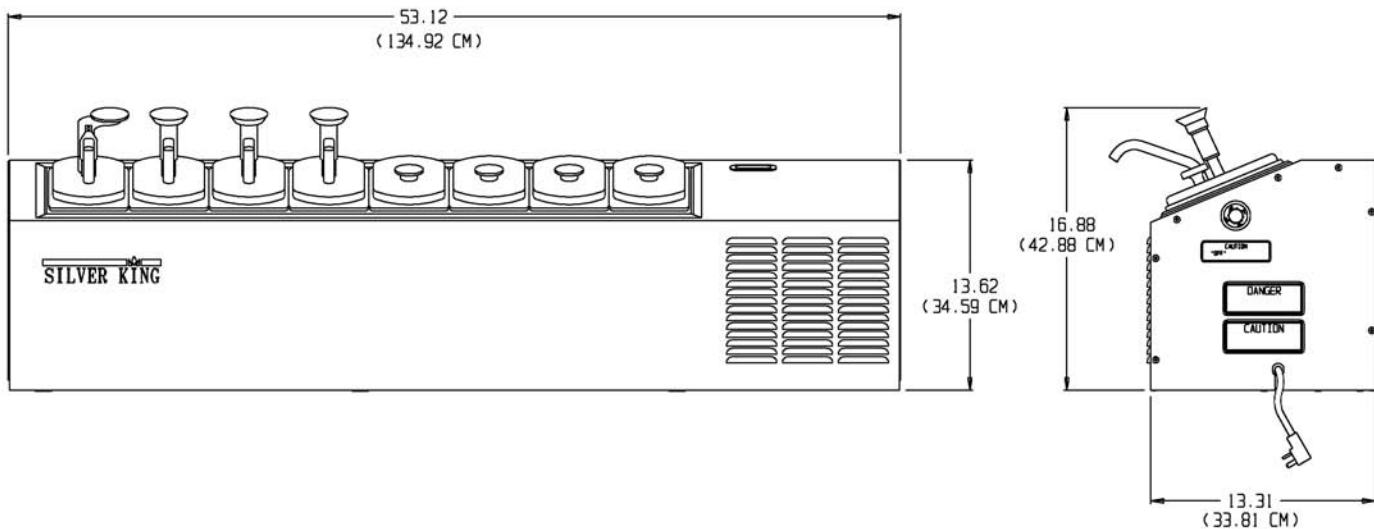

1600 Xenium Lane North
 Minneapolis, MN 55441-3787
 Phone (763) 923-2441
 Fax (763) 553-1209
www.silverking.com

#FNSKRCF04
 © Silver King 2004
 Printed in U.S.A.