

# Bubbler Valves



## Model 5017LF

Integral, self-closing, push button valve with adjustable pressure compensation stream regulator. Integral, chrome plated brass basin shank; 1/2" O.D. slip joint supply. Vandal resistant pin prevents turning of fixture. Designed for deck or sink mounting. This valve exceeds the standards of the Safe Drinking Water Act and Lead Contamination Control Act. All components in the waterway contain less than 0.1% lead. Dimensions: bottom of flange to bubbler orifice, 2"; shank length, 2 1/4"; flange diameter, 2"; shank diameter, 13/16".

### Servicing Instructions for Model 5017LF:

If stream height of water is unsatisfactory, remove hex nut (5) and button (4) and adjust stream by turning slotted adjusting screw: clockwise to raise, counter clockwise to lower. If this fails to improve stream replace the cartridge assembly.

### To Replace Cartridge in Model 5017LF:

- ❶ Shut off water supply.
- ❷ Unscrew hex nut.
- ❸ Remove button.
- ❹ Remove retaining nut with wrench.
- ❺ Remove cartridge and gasket.
- ❻ Insert new cartridge and gasket.
- ❼ Reassemble parts in reverse order.

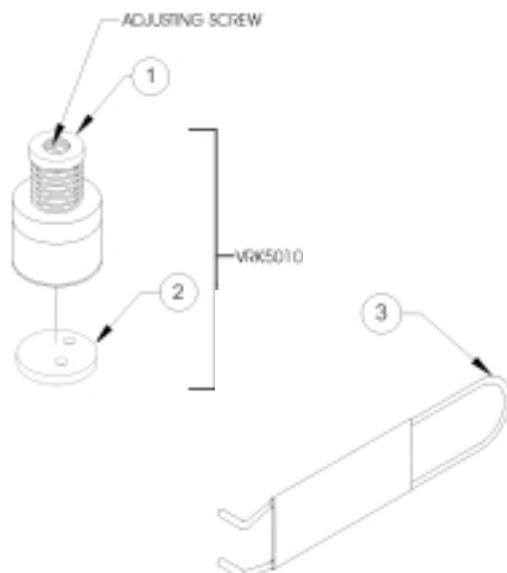
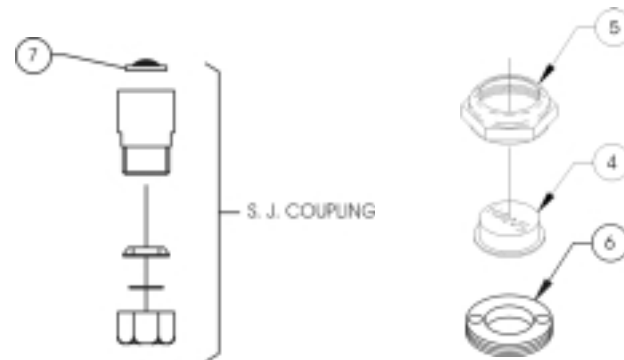
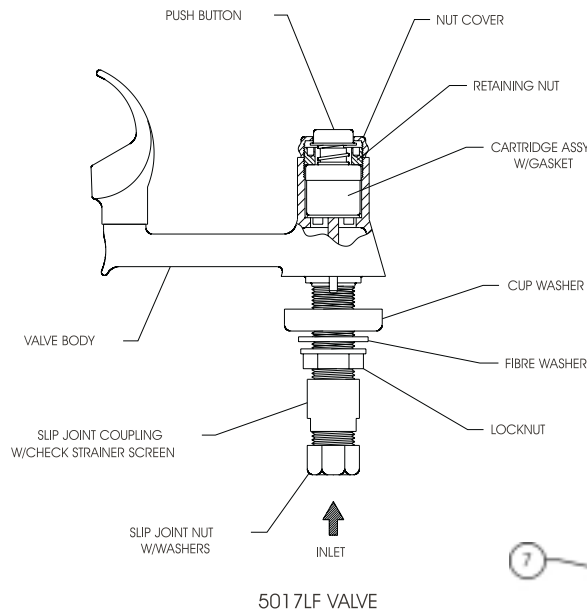

Repl. Part #	Item	Description
VRK5010	1	Cartridge Assembly (Includes Gasket)
	2	Gasket 5017LF
0006983506	3	Wrench Spanner for Retainer Nut Removal
0001333699	4	Button - Push
0003849387	5	Nut Cover, Hex
0003849394	6	Nut, Retainer
0004956308	7	Strainer Screen



Certified to NSF-61 Section 9

LEAD FREE