

# Valves



## Model 5851LF

Lead free polished chrome plated, panel mounted, self-closing, lever handle valve with rough brass body and vandal resistant handle. This valve exceeds the standards of the Safe Drinking Water Act and Lead Contamination Control Act. All components in the waterway contain less than 0.1% lead. Dimensions: wall thickness maximum, 1"; size of hole required, 1 1/16" diameter. 3/8" NPT(F) inlet and outlet. Replaces Models 5850, 5855 and 5856.

## Model 5851LFX

Same as above but with polish chrome plated 4 arm handle.

### Service Instructions for Models 5851LF & 5851LFX:

To repair these valves order the 5800VRKM or 5851HS handle and stem assembly. Valves has no stream adjustment and require a flow control, see page 32.

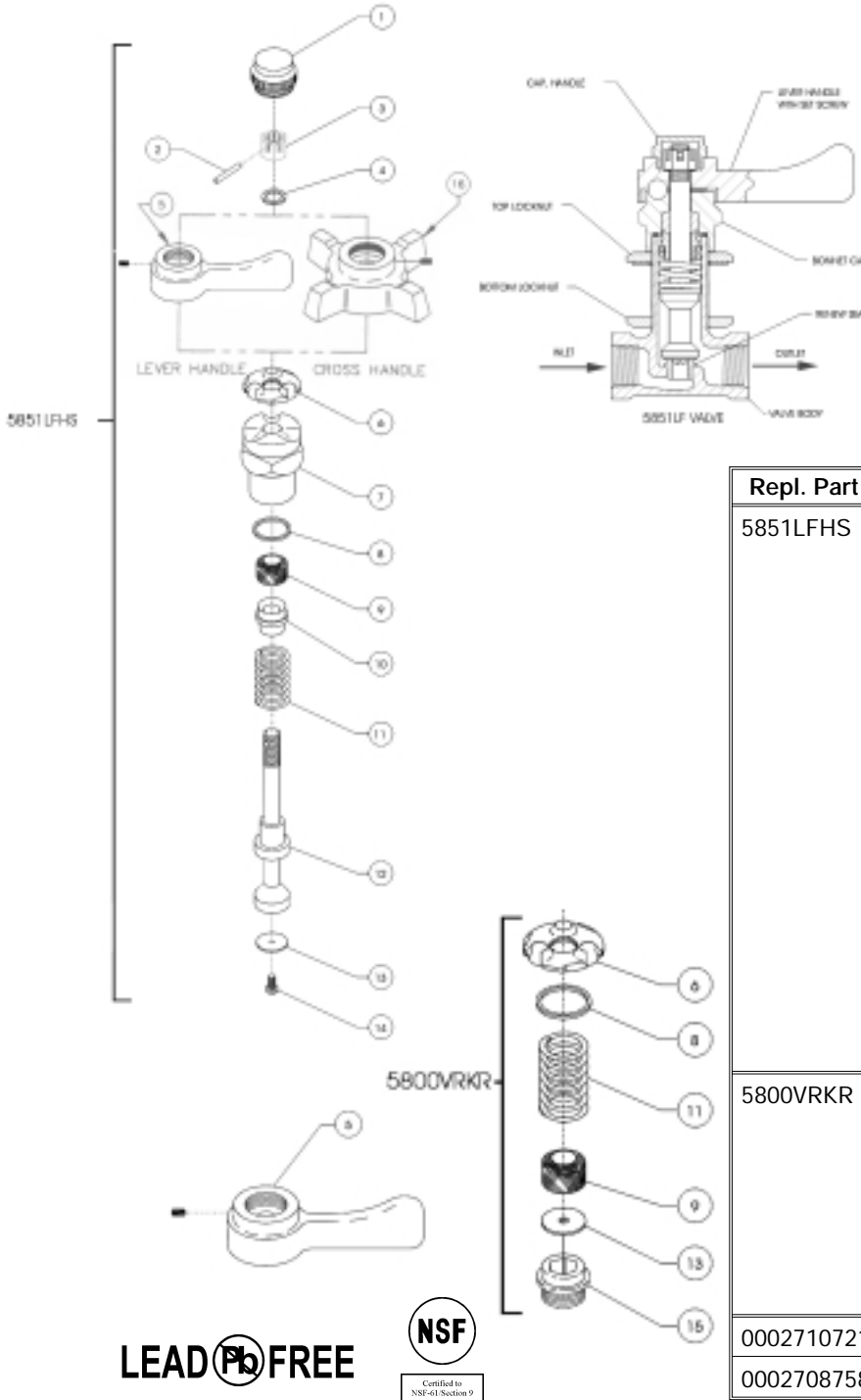

Repl. Part #	Item #	Description
5851LFHS	1	Cap Handle PCP
	2	Pin-Lock
	3	Nut, Thrust
	4	Washer, Thrust
	5	Handle, Lever with Set Screw
	6	Retainer Ball
	7	Bonnet Cap
	8	Washer, Bonnet
	9	Packing Felt
	10	Gland Packing
	11	Spring
	12	Stem
	13	Washer Seat
	14	Screw, Seat Washer
5800VRKR	6	Retainer Ball
	8	Washer, Bonnet
	9	Packing Felt
	11	Spring
	13	Washer Seat
15	Seat, Renew	
0002710721.1	5	Handle, Lever with Set Screw
0002708758	16	Handle, Cross with Set Screw