

Model 5872

Lead free push button activated valve with automatic diaphragm pressure regulator and fully adjustable flow. 1/4" NPT(F) inlet and outlet. Body is manufactured of glass filled Celcon. Valve functions with water pressure from 20 to 90 PSI. Used on most Haws drinking fountains. This valve exceeds the standards of the Safe Drinking Water Act and Lead Contamination Control Act. All components in the waterway contain less than 0.1% lead. Push button assembly not included. See page 26. Model 5972 comes with Model 6420 strainer.



Model 5872HF

Similar to Model 5872 except used with fountains requiring higher water flows such as cuspidor units. This valve exceeds the standards of the Safe Drinking Water Act and Lead Contamination Control Act. All components in the waterway contain less than 0.1% lead.

Servicing Instructions for Models 5872 and 5872HF:

This valve is adjustable. Do not adjust flow with screwdriver stop. Leave screwdriver stop in full open position. Valve will compensate for wide supply pressure fluctuations. It must be protected from debris by the fine mesh strainer Model 6420 supplied with unit. See page 35.

For higher flow, adjust valve by threading knurled adjusting ring further on to push-button assembly. For lower flow, back adjusting ring off push-button assembly. Lock knurled adjusting ring in position with adjustment locknut. Bubbler stream may lower during short break-in period. Set initial stream height a little high to minimize or eliminate the need for break-in period readjustment

FRONT ADJUST OPTION: A hole in the center of the push button indicates the presence of a front adjustment screw. Using a 5/32" Allen wrench, the flow may be adjusted by inserting into the hole and turning clockwise for increased flow and counter clockwise for decreased flow. Hold button to prevent spinning while adjusting flow.

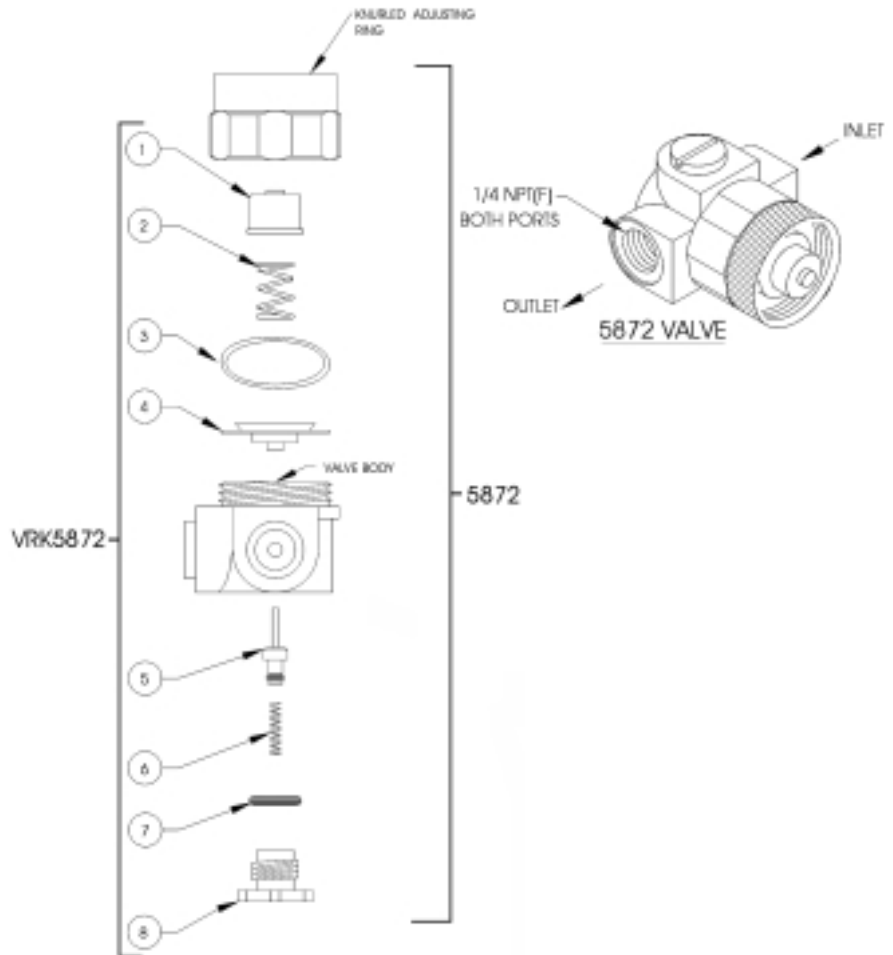

Repl. Part #	Item #	Description
VRK5872	1	Button, Push
	2	Spring, Adjusting
	3	Ring Slip, Diaphragm
	4	Diaphragm Assembly
	5	Stem, Valve
	6	Spring, Bottom
	7	"O" Ring, Bottom Plug
	8	Plug, Bottom

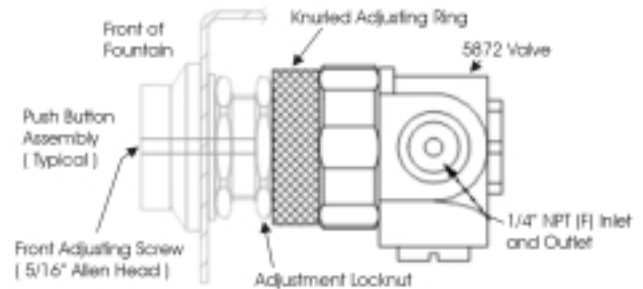

5872 Typical Installation



Certified to NSF-61 Section 9

LEAD **Pb** FREE