

Bib Faucets

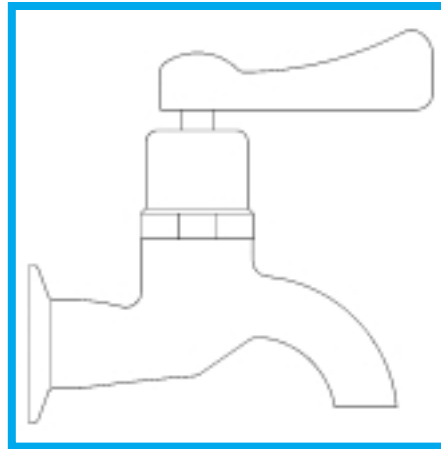

Model 6248 Series

Model 6248

Self-closing, plain end lead free brass bib faucet assembly with polished chrome plated finish. Assembly includes extension nipple, locknuts, and tee. This assembly was used on Model 3300 pedestal drinking fountain. 1/2" NPT(F) inlet. This bib faucet exceeds the standards of the Safe Drinking Water Act and Lead Contamination Control Act. All components in the waterway contain less than 0.1% lead. This faucet is discontinued and has been replaced by Model 6250LF.

Model 6248.60

Self-closing, plain end bib faucet assembly with polished chrome plated finish. Assembly includes stainless steel mounting plate, mounting screws, extension nipple, and tee. This assembly was used on Models 3060, 3121, 3150 and 3177 concrete pedestal fountains that come equipped with a second access plate opening. 1/2" NPT(F) inlet. This bib faucet exceeds the standards of the Safe Drinking Water Act and Lead Contamination Control Act. All components in the waterway contain less than 0.1% lead. This faucet is discontinued and has been replaced by Model 6250.60LF.

Model 6248.76

Self-closing, plain end bib faucet assembly with polished chrome plated finish. Assembly includes extended supply shank, which facilitates installations for walls with thickness up to 3", lock nut, and tee. This assembly was used on pedestal drinking fountains with walls up to 3" thick. 1/2" NPT(F) inlet. This bib faucet exceeds the standards of the Safe Drinking Water Act and Lead Contamination Control Act. All components in the waterway contain less than 0.1% lead. This faucet has been discontinued.

Servicing Instructions for Models

6248, 6248.60 and 6248.76:

To repair this valve, order the VRK5832. Order the 5832HS to replace damaged or worn parts in the handle and stem assembly.

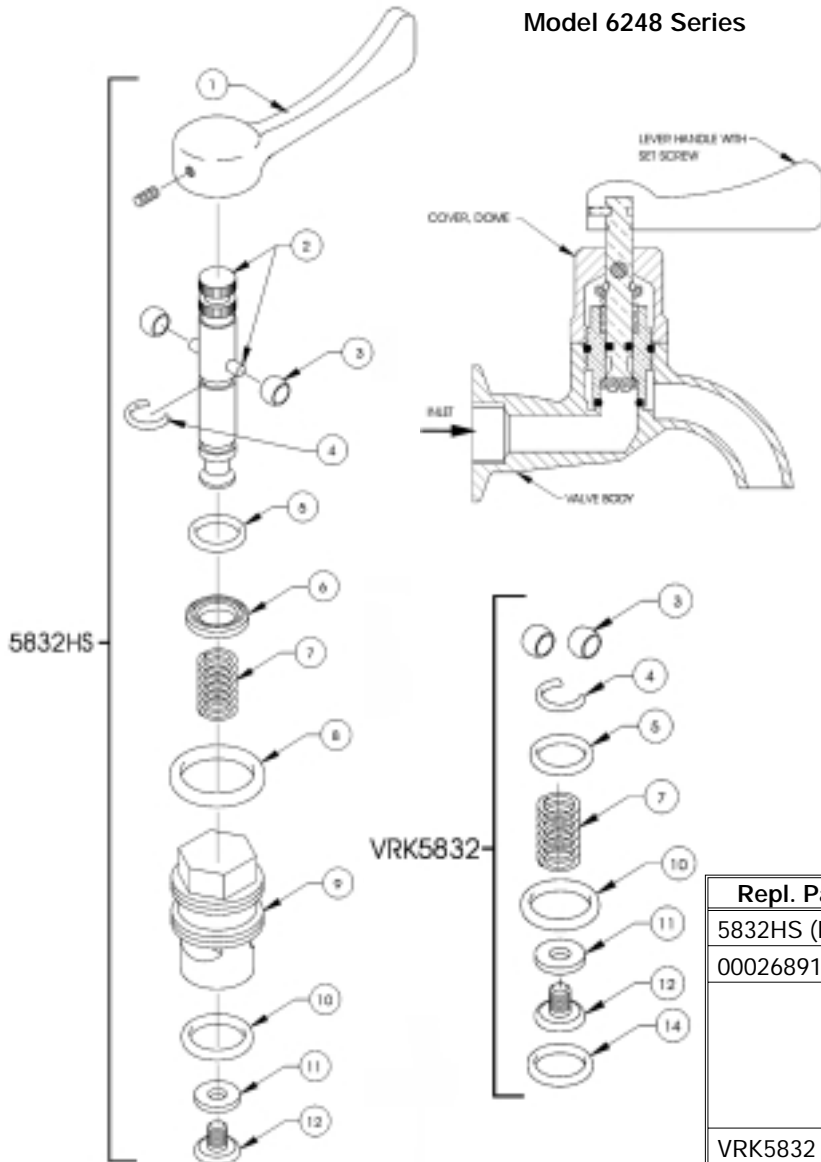

Repl. Part #	Item #	Description
5832HS (Includes items 1-12)		
0002689100	1	Handle Lever Blank with Set Screw
	2	Spindle with Pin
	6	Washer Retainer
	8	"O" Ring Cover
	9	Cover
VRK5832	3	Roller (2 req'd)
	4	Circlip
	5	"O" Ring Spindle
	7	Spring
	10	"O" Ring Seal
	11	Washer Neoprene
	12	Screw, Seat Washer Retainer

LEAD  FREE



Certified to
NSF-61 Section 9